

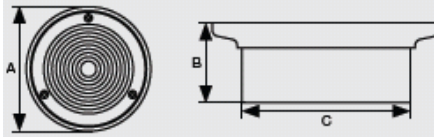

Product Data Sheet

UNICLASS L7315	
Cl/Sfb	(52.6)
October 2012	

VX-F015 Circular rodding eye nickel bronze



150mm Circular Rodding Eyes (NPSM threaded or Direct Fit)

GEN code	Material	FIT	Finish		A	B	C	WTKG
VX-F015	Nickel Bronze	NPSM	Standard 227105	Polished 234182	150	53	110	1.8
VX-F015	Nickel Bronze	Direct Fit	Standard 233426	Polished 234183	150	53	110	1.8

General Description

150mm circular nickel bronze rodding eye with a NPSM thread or plain spigot for direct fit. Supplied in a standard finish or in a polished finish to order.

Technical Specification

Material: Nickel bronze
Loading: K3

Compatible Items

NPSM grating: All cast iron Floor gullies VX-F200, VX-F210, VX-F220, VX-F230
Raising pieces VX-F350

Direct fit grating: Pipework 110mm OD
Ensign, EEZI-FIT, Timesaver 416, other materials 110mm OD
Timesaver 437 using a TD02 stepped coupling

Options Security screws (bag of 4) VX-F420



Saint Gobain PAM
Lows Lane, Stanton-by-Dale
Ilkeston, Derbyshire, DE7 4QU
Sales : 0115 930 0630

Technical T:01952 262 529 F: 01952 262 592
E: technical.soildrain.uk.pam@saint-gobain.com