

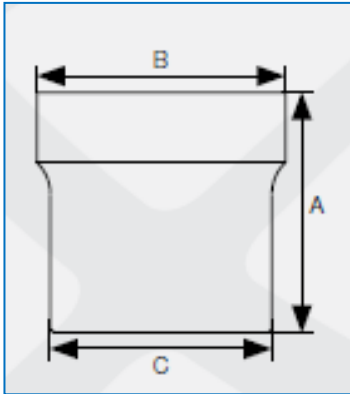

Product Data Sheet

UNICLASS L7315	
Cl/Sfb	(52.6)
March 2014	R1

VX-F210 Sumpless Body



Sumpless Body (110mm outlet)

GEN code	SAP code	Material	A	B	C	WTKG
VX-F210	227120	Cast Iron	124	120	110	1.6

General Description

Cast iron sumpless body 110mm OD outlet, NPSM flange thread.

Technical Specification

Material:	Cast iron – BS EN 1561
Coating:	Grey epoxy to an average thickness of 70micron internally / externally
Connection:	110mm OD

Compatible Items

Gratings / Rodding eyes:	VXF010 – VXF085 NPSM thread – Nickel Bronze / Stainless steel
Raising pieces:	VX-F350
Pipework:	Ensign, Timesaver 416 , Other materials 110mm OD Timesaver 437 using TD02 stepped coupling

Flowrate@20mm head

Untrapped gratings	= 1.9 to 3.0 L/s (depending on grating available on request)
All trapped gratings	= 0.9 L/s



Saint Gobain PAM
 Lows Lane, Stanton-by-Dale
 Ilkeston, Derbyshire, DE7 4QU
 Sales : 0115 930 0630
 Technical T:01952 262 529 F: 01952 262 592
 E: technical.soildrain.uk.pam@saint-gobain.com

* PLEASE NOTE: At the time this data sheet was prepared all the data shown was accurate at the time of release.