

UNICLASS G5811: L7312		
Cl/Sfb		(5.5)
2019		

## EF058 – Movement Connector

Product code	Dia	A	B	C	D	WTKG
192304	100	145	300	200	170	4.4
156235	150	202	310	200	170	7.8

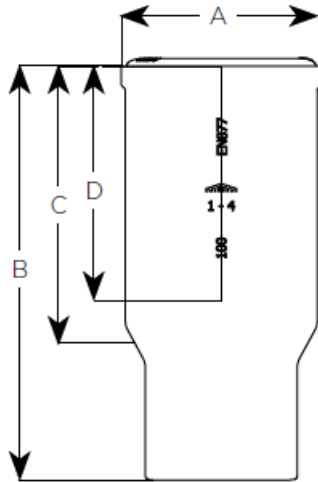

### General Description

Movement Connector which accommodates building Settlement

### Technical Specification

- Product code:** See Table
- Standard:** BS EN 877: 1999/AC: 2008
- Material:** Cast Iron – BS EN 1561
- Coating:** Red epoxy to an average thickness of 70microns
- Gasket Material:** EPDM Rubber EN 681
- System Fire Rating:** A1
- Water Temperature Rating:** 95° +/- 2° (Resistance to Hot Water in 24hr cycle constant)

### Product Identification

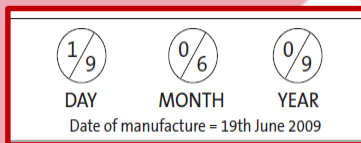

### CE Marking Certificate

 SAINT-GOBAIN PAM UK Lows Lane Stanton-by-Dale - Ilkeston Derbyshire DE7 4QU 08	
Unique identification code of the product-type: E001A Declaration of Performance N°DoP-001UK AVCP: 3 for reaction to fire (Range) 4 for all other characteristics EN 877:1999/AC:2008	
Cast iron pipes and fittings, their joints and accessories for the evacuation of water from buildings ENSIGN S (Soil) Range Pipes, fittings and couplings DN 50-600	
Reaction to fire	A1
- Cast iron	A1
- Range	A1
Internal pressure strength	Conform
Dimension tolerances	Conform
Impact resistance	Conform
- Mechanical properties (pipes)	
• Tensile strength	300 MPa (average value)
• Ring crush strength	450 MPa (average value)
• Brinell hardness	220 HB (average value)
Tightness	Conform
- Water tightness *	
Internal pressure	
DN ≤ 200	≥ 5 bar
DN > 200	≥ 3 bar
* excluded flexible couplings, joints connecting to sanitary ware ...)	
Durability	Conform
- External coatings	
• Pipes	Acrylic/Conform
• Fittings	Epoxy/Conform
- Internal coatings	
• Pipes **	Epoxy/Conform
• Fittings **	Epoxy/Conform
** including resistance to salt spray	≥ 1500 h

**Saint Gobain PAM**  
 Lows Lane, Stanton-by-Dale  
 Ilkeston, Derbyshire, DE7 4QU  
 Sales : 0115 930 0630  
 Technical T:01952 262 529 F: 01952 262 592  
 E: technical.soildrain.uk.pam@saint-gobain.com



\* PLEASE NOTE: At the time this data sheet was prepared all the data shown was accurate at the time of release.