

Vented cover detail.

M12 STAINLESS STEEL
CSK SLOT HEAD SET SCREW

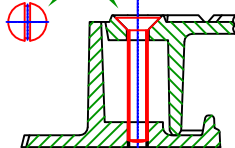

TYPICAL SCRAP SECTION SHOWING
OPTIONAL BOLTING DOWN OF COVER TO FRAME

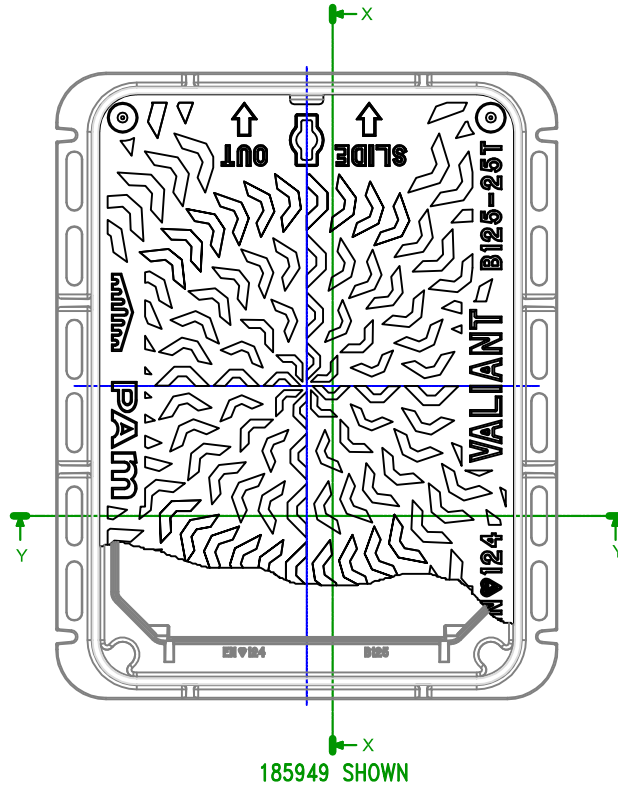

185949 SHOWN

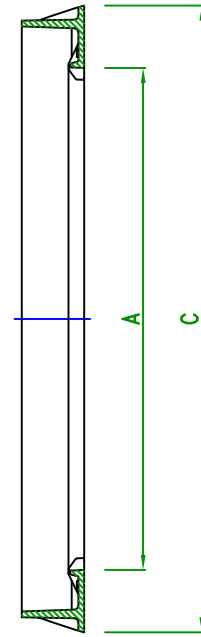

Section X-X cover removed

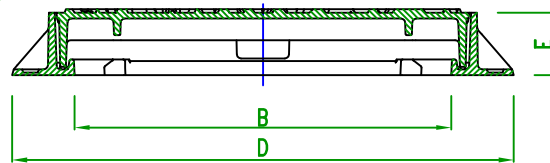

Section Y-Y

USE LIFTING KEY(S):

- 190668 (RMA57) 610mm LONG
- 190667 (RMA56) 467mm LONG
- 190666 (RMA55) 381mm LONG
- C50 (RMA62) 152mm LONG

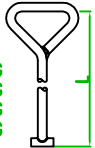

ERGONOMIC LIFTING KEY
190670 (RMA60)

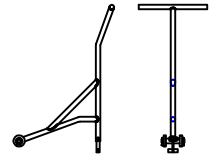

**VALIANT SINGLE SEAL CLASS B125 DUCTILE IRON
SLIDE OUT MANHOLE COVER & FRAME.**

FOR PEDESTRIAN AREAS WITH ACCESS BY LIGHT VEHICLES

SAP CODE STANDARD	STANCAD CODE STANDARD	SAP CODE SCREWED 2 SLOT HD	SAP CODE SCREWED 4 SLOT HD	EN124 CLASS	CLEAR OPENING A x B	OVER BASE C x D	DEPTH E	COVER MASS kg	TOTAL MASS kg	VENT AREA CM SQ	REPLACES PRODUCT REF.	BEARING PRESSURE N/mm ²	PALLET QUANTITY
185949	BM02 1	199553	TBC	B125	600 x 450	755 x 605	75	33	53	N/A	C5467	0.71	10
185959	BM06 1	185960	211345	B125	600 x 600	755 x 755	75	41	63	N/A	C5468	0.63	10
# 185964	BM54 1	204852	TBC	B125	900 x 600	1070 x 770	75	59	89	N/A	C5474	0.46	10
* 185958	BM04 1	TBC	TBC	B125	600 x 450	755 x 605	75	32	52	104	-	0.71	10
* 185963	BM08 1	TBC	TBC	B125	600 x 600	755 x 755	75	40	62	165	-	0.63	10
#* 185966	BM57 1	TBC	TBC	B125	900 x 600	1070 x 770	75	58	88	165	-	0.46	10

* Ventilated covers
Push Fit Seal Capable

SEAL SYSTEM IS DESIGNED TO PREVENT THE EGRESS OF ODOURS WHEN THE SEALING GROOVE IS FILLED WITH A SUITABLE SEALING MEDIUM (IE. WATERPROOF GREASE)
NB. THIS IS NOT A PRESSURE TIGHT SEAL

COPYRIGHT and DESIGN RIGHT
This drawing is the exclusive property of Saint Gobain PAM UK and is confidential and must not be reproduced or disclosed to any third party without written consent.
It must be used only for the purpose for which it has been issued and is returnable on request.

Produced at Holwell
Works in UK



FEATURE	CLASS	APPLICATION	GROUP	KITEMARK	DRAWN	DATE FIRST ISSUED	DRAWING TITLE	ISSUE
SLIDE OUT	EN124 B125	 	2		JNP	25/1/06	Valiant B125 (BM)	13
					SCALE NTS	DATE THIS ISSUE 08/01/14		

The information on this sketch is, to the best of our knowledge correct at the time of printing. However Saint-Gobain are constantly looking at ways of improving their products and services and therefore reserve the right to change, without prior notice, any of the data shown. Any orders placed will be subject to our Standard Conditions of Sale, available on request.